



# YNF MACHINERY

[www.ynfmachinery.com](http://www.ynfmachinery.com)

Guangzhou Xiebang Machinery Co., LTD



**YNF MACHINERY**

GUANGZHOU XIEBANG MACHINERY CO., LTD

地址: 广东省广州市天河区珠吉路36号珠吉国际机械市场10街1021/1023档

手机微信同号: 137 6336 7453

固话: 020-3236 4713

ADD: No. 1021 & 1023 Street 10 Zhuji Market, No. 36 Zhuji Road,  
Tianhe District, Guangzhou, Guangdong province, China

Mob./WhatsApp: +86 189 2425 0310 / +86-1360 2850 555

Tel: 0086-20-3236 4713

FAX: 0086-20-3236 4713

E-MAIL: [sales@ynfmachinery.com](mailto:sales@ynfmachinery.com) / [sales@ynfrubber.com](mailto:sales@ynfrubber.com)

Website: <https://www.ynfmachinery.com>

<https://www.ynfrubber.com>

2022 Version

<https://www.ynfmachinery.com>  
<https://www.ynfrubber.com>



**About YNF:**

YNF is a brand owned by Guangzhou Xiebang Machinery Co., Ltd, which focuses on excavator parts like couplings, mounts, hoses, hydraulic parts, seal kits and gear parts, etc.



**Guangzhou Office:**

Our Office and showroom are located in Guangzhou, Tian He district. The professional logistic industry in Guangzhou enables us provide fast delivering service to our customers. We attend the Construction Machinery Exhibitions all over the world every year.

**Our Factory:**

Our excavator parts factory was set up in 1988 in Kaiping city, Guangdong province. And in year 2011 we set up the 2nd factory. Now we are the largest excavator rubber parts supplier in southern China. Factory occupies 4000 square meters and has several full sets of excavator parts production line, around 80 professional workers, 20-million annual production capacity.

Factory manager Mr. Zhang has 24 years excavator parts industrial & manufacture experience. Factory R&D and QC team are rich experienced in excavator parts production line.

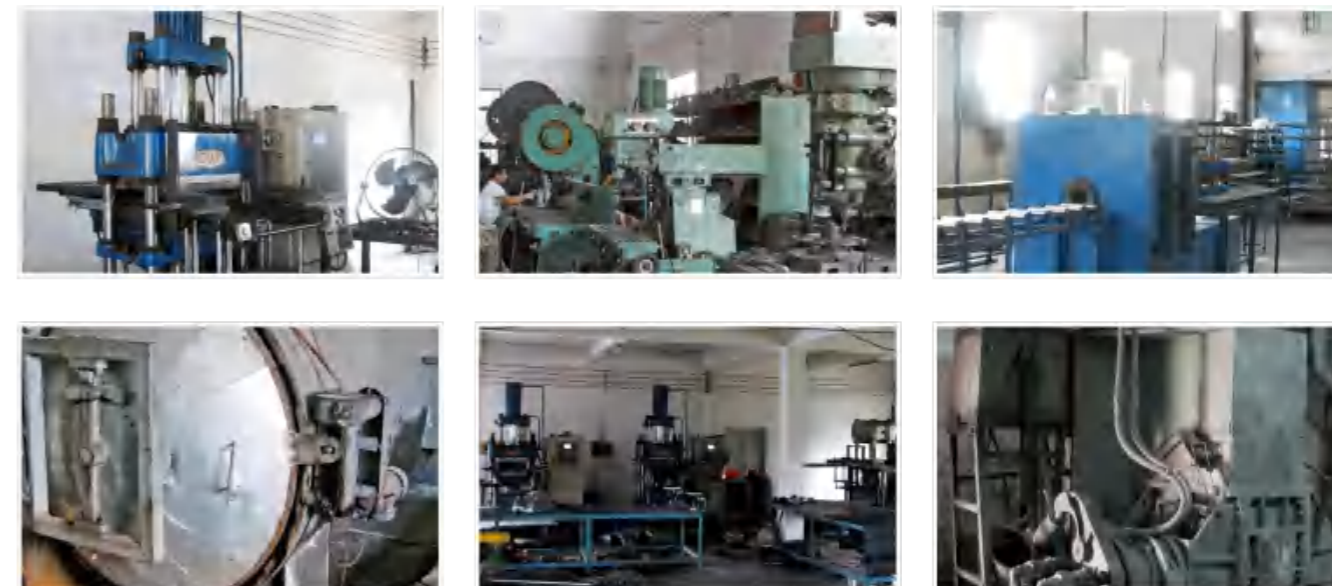

**Who We Serve:**

Our clients include agents and distributors globally. We also sell excavator parts to final customers in USA, Canada, Australia and Europe.

**OEM Welcomed:**

Our own factory can make the rubber & iron parts according to customer requirement.

**Our Value:**

Honest, Positive, Collaborative



## Coupling - H



YNF-001  
16H (PU)



YNF-002  
16H (PU+AL)



YNF02454  
16H (AL)



YNF-003  
25H (PU) A type



YNF-004  
25H (PU+AL) A type



YNF02455  
25H (AL) A type



YNF-005  
25H (PU) B type



YNF-006  
25H (PU+AL) B type



YNF02456  
25H (AL) B type



YNF01204  
25H (IR) B type



YNF02459  
25H (PU+AL+IR) B type



YNF-007  
30H (PU)



YNF-008  
30H (PU+AL)



YNF02457  
30H (AL)

## Coupling - H



YNF-009  
35H (PU)



YNF-010  
35H (PU+AL)



YNF02458  
35H (AL)



YNF-011  
40H (PU)



YNF-012  
40H (PU+AL)



YNF02460  
40H (AL)



YNF-013  
45H (PU)



YNF-014  
45H (PU+AL)



YNF02461  
45H (AL)



YNF-015  
50H (PU)



YNF-016  
50H (PU+AL)



YNF02462  
50H (AL)



YNF-017  
90H (PU)



YNF-018  
90H (PU+AL)



YNF02463  
90H (AL)

## Coupling - H



YNF-019  
110H (PU)



YNF-020  
110H (PU+AL)



YNF00638  
110H (AL)



YNF03349  
130H (PU)



YNF03350  
130H (PU+AL)



YNF03351  
130H (AL)



YNF-021  
140H (PU)



YNF-022  
140H (PU+AL)



YNF00962  
140H (AL)



YNF02346  
140H (IR)



YNF02464  
140H (PU+AL+IR)



YNF-023  
160H (PU)



YNF-024  
160H (PU+AL)



YNF2342  
160H (AL)

## Coupling - H / K



YNF-025  
240H (PU)



YNF-026  
240H (PU+AL)



YNF02465  
240H (AL)



YNF02343  
500H (PU)



YNF02344  
500H (PU+AL)



YNF02466  
500H (AL)



YNF01762  
25K (PU)



YNF02345  
25K (PU+AL)



YNF02467  
25K (AL)



YNF01746  
50K (PU)



YNF01747  
50K (PU+AL)



YNF02468  
50K (AL)



YNF01748  
110K (PU)



YNF01749  
110K (PU+AL)



YNF02469  
110K (AL)

## Coupling - K



**YNF01750**  
160K/165K (PU)



**YNF-027**  
240K (PU)



**YNF01752**  
550K (PU)



**YNF03813**  
352+165K Ass'y



**YNF01751**  
160K/165K (PU+AL)



**YNF-028**  
240K (PU+AL)



**YNF01753**  
550K (PU+AL)



**YNF02470**  
160K/165K (AL)



**YNF02471**  
240K (AL)



**YNF02486**  
550K (AL)

## Coupling - H

广州携邦机械设备有限公司所提供的联轴器(连接胶)具有优秀的线性抗衰扭的性能.

我们提供的联轴器(连接胶)众多,具有不同的橡胶硬度组合以供选择:

注释: ● ◎ ○ △ ×

有此功能(强) ←→ 无此功能(弱)

The couplings provided by YNF have excellent linear anti-twisting performance.

We offer a wide range of couplings with different rubber hardness combinations to choose from.

Note: ● ◎ ○ △ ×  
strong ↔ weak

类型 Series	 A/AS	 H/K
扭矩 ( N.m ) torque	10~4000	100~2500
规定下的扭矩扭转角 (°)	3~6	0.2~0.3
材质 Material	天然橡胶NR	热塑性聚酯弹性体
工作适宜温度 (°C)	-30~+85	-40~+120
耐油性 Oil resistance	×	●
允许调整范围	平行偏移	○
	角偏移	△
	轴向位移	●
功能和应用	抗震动、抗冲击、灵活性高、耐油性强 应用: 工程机械、发电机、压缩机、通用工业机械	抗震动、抗冲击、耐高温、耐油性强、容易安装和拆卸 应用: 工程机械



### 优秀的抗震火热抗冲击性能

弹性酯树脂在运作过程中可以起到橡胶一样的优良抗震吸震性能。



### 在恶劣环境条件下有更好的抵抗力

这种材料在高温，低温和油脂环境里的抵抗力更强。



### 优质耐用

聚酯树脂是联轴器（连接胶）耐用的保证，而长期工作寿命也可以缩短扭矩传送建设的时间。枢纽和花键轴都是完全固定在机器上，几乎无磨损转动对维修是要求很低。



### 容易安装和拆卸

输入和输出可以通过转动轴向来轻松连接和断开。

正常工作扭矩[N.m]	100~2500	
导向孔、额外加工范围[mm]	ø13~115	
工作温度[°C]	-40~+120	
齿隙	Yes	
最大允许调整范围	平行偏移[mm]	0.3~0.4
	角位移动[°]	0.5
	轴向位移[mm]	±3

## STRUCTURE AND MATERIAL

### 结构与材质

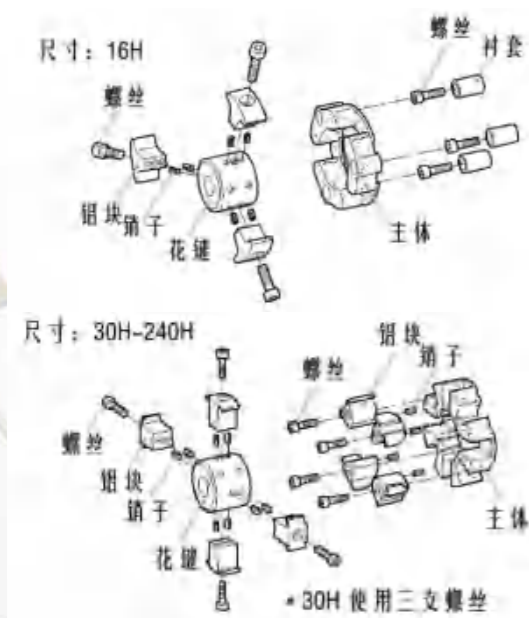

## BODY SHAPES OF DIFFERENT SIZES

### 各个尺寸的主体形状

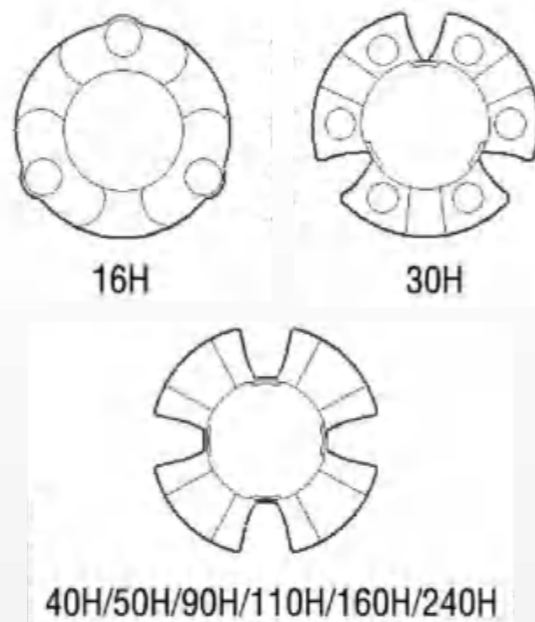

## SPECIFICATIONS

### 规格

型号	扭矩		最大调整范围			最大转速	动态扭转弹簧常数
	正常扭矩 [N.m]	最大扭矩 [N.m]	平行偏移 [mm]	角位移 [°]	轴向位移 [mm]		
8H	100	200	0.3	0.5	±3	6500	1.27x10 <sup>4</sup>
16H	200	400	0.3	0.5	±3	5500	2.46x10 <sup>4</sup>
30H	400	800	0.4	0.5	±3	4000	5.91x10 <sup>4</sup>
40H	600	1200	0.4	0.5	±3	4000	1.87x10 <sup>4</sup>
50H	800	1600	0.4	0.5	±3	4000	1.91x10 <sup>4</sup>
90H	950	1900	0.4	0.5	±3	4000	2.69x10 <sup>4</sup>
110H	1100	2200	0.4	0.5	±3	4000	2.79x10 <sup>4</sup>
160H	1600	3200	0.4	0.5	±3	3600	5.11x10 <sup>4</sup>
240H	2500	5000	0.4	0.5	±3	3000	5.10x10 <sup>4</sup>

型号	转动惯量 [kg·m <sup>2</sup> ]	重量 (kg)
8H	9.4x10 <sup>-4</sup>	0.4
16H	3.0x10 <sup>-3</sup>	0.8
30H	9.2x10 <sup>-3</sup>	1.5
40H	6.9x10 <sup>-3</sup>	1.5
50H	1.2x10 <sup>-2</sup>	1.8
90H	1.5x10 <sup>-2</sup>	2.5
110H	2.3x10 <sup>-2</sup>	2.6
160H	3.6x10 <sup>-2</sup>	3.5
240H	1.02x10 <sup>-1</sup>	6.5

## SIZE

### 尺寸

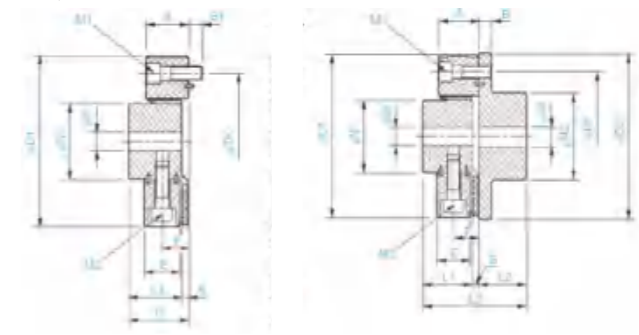

·动态扭转弹簧的特点是非线性，动态扭转弹簧常数应设置在额定转轴或是其最高值的20%左右。  
·动态扭转弹簧常数是静态扭转弹簧常数的1.3倍。  
·惯性和质量的时刻价值是基于先导孔的圆柱和凸缘中心。  
作为员工基本的安装方法，建议用镶嵌对齐。

型号	d1	d2	D1	D2	N1	N2	L1	L2	L3	A	B	B1	C	E	F	S	TK	M1=m2		
	导向孔 最大值	导向孔 最大值																		
8H	12	38	15	46	125	120	60	70	40	42	88	32	10	10	46	25	20	6	100	3-M10
16H	15	48	19	56	150	150	70	85	52	50	110	41	12	12	60	34	26	8	125	3-M12
30H	20	65	28	80	200	200	100	120	68	66	144	56	16	15	78	46	35	10	165	3-M16
40H	22	50	22	65	180	180	85	100	58	56	124	50	16	16	68	42	31	10	140	3-M16
50H	20	65	28	80	200	200	100	120	68	66	144	56	16	15	78	46	35	10	165	3-M16
90H	20	65	28	80	200	200	100	120	68	66	144	56	16	15	78	46	35	10	165	3-M16
110H	25	63	28	80	230	230	100	120	68	66	144	56	18	18	78	46	35	10	180	3-M18
160H	30	85	30	95	260	260	125	140	84	80	177	59	19	20	97	48	37	13	215	3-M20
240H	40	115	40	120	320	320	160	180	100	100	213	65	19	20	113	54	40	13	260	3-M20

## Coupling - A/AS

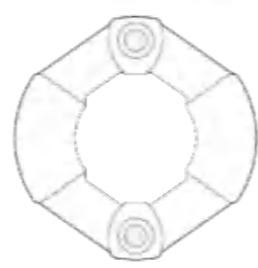
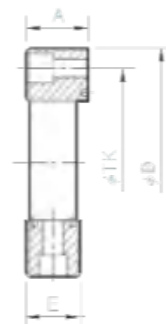

Size 001, 002

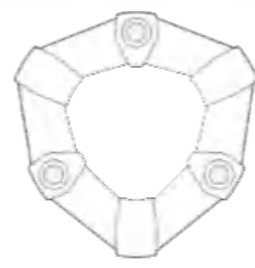

Size 004, 008, 016  
025, 030, 090

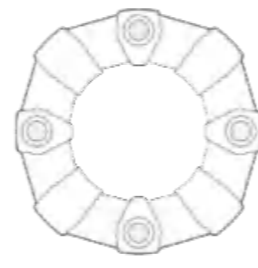

Size 012, 022, 028, 050  
080, 140, 200, 250, 400

Size	System Code	D(mm)	TK(mm)	A(mm)	E(mm)
1	Pending	56	44	24	22
2	YNF02338/02339	85	68	24	20
4	YNF-029/030	100	80	28	24
8	YNF-031/032	120	100	32	28
12	YNF-157/158	120	100	32	28
16	YNF-033/034	150	125	42	36
22	YNF-035/036	150	125	42	36
25	YNF-037/038	170	140	46	40
28	YNF-039/040	170	140	46	50
30	YNF-041/042	200	165	58	50
50	YNF-043/044	200	165	58	61
80	YNF-045/046	205	165	65	62
90	YNF-047/048	260	215	70	62
140	YNF-049/050	260	215	70	72
200	YNF-051/052	300	250	80	77
250	YNF-053/054	340	280	85	95
400	YNF-055/056	370	300	105	11
600	Pending	470	380	125	0
800	Pending	545	370+470	145	128

## Coupling - A/AS

The difference between A type holes and AS type holes.

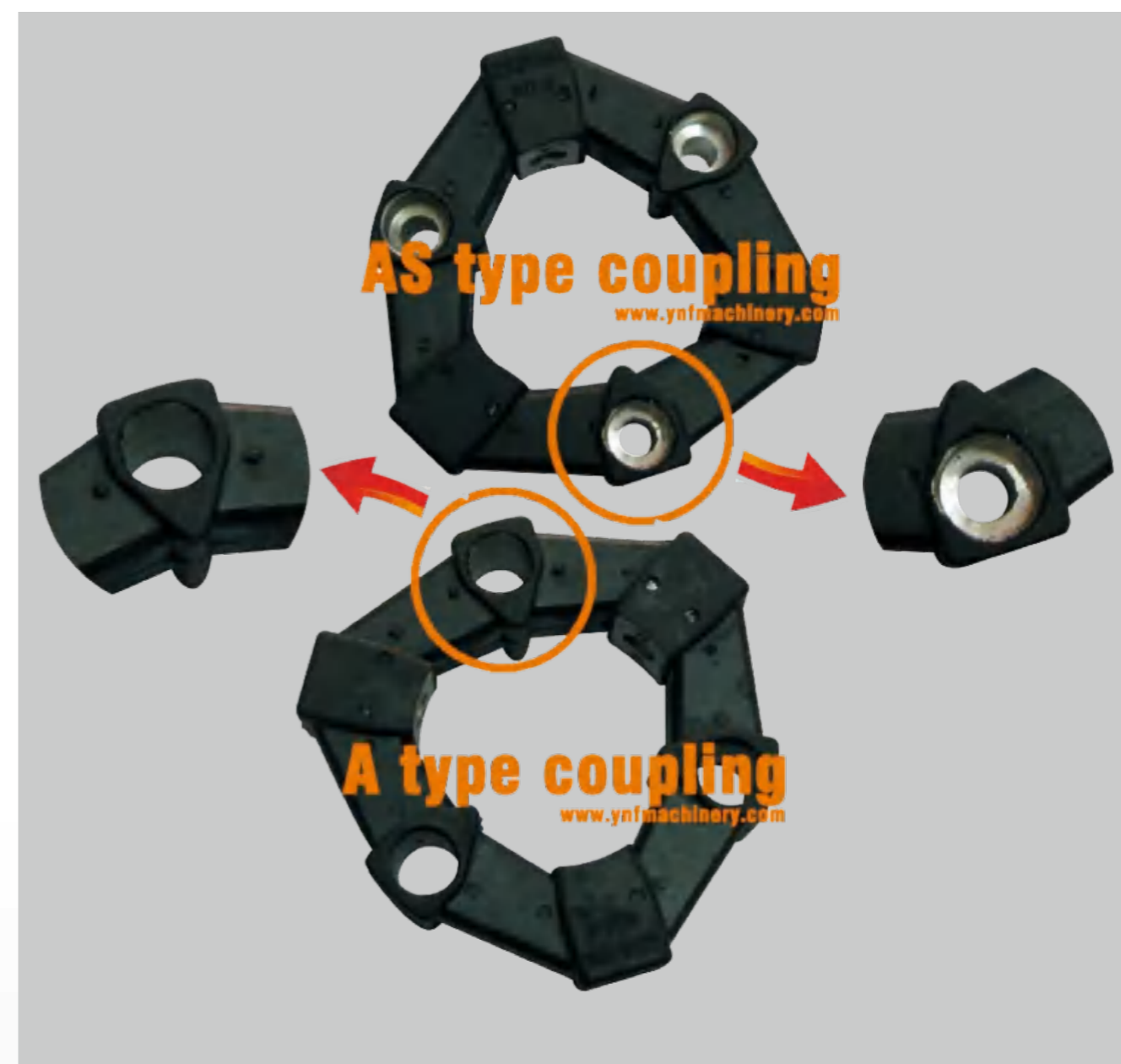

## Coupling - A/AS



YNF02338  
2A



YNF02339  
2AS



YNF-029  
4A



YNF-030  
4AS



YNF-031  
8A



YNF-032  
8AS



YNF-157  
12A



YNF-158  
12AS



YNF-033  
16A



YNF-034  
16AS



YNF-035  
22A



YNF-036  
22AS



YNF-037  
25A



YNF-038  
25AS



YNF-039  
28A

## Coupling - A/AS



YNF-040  
28AS



YNF-041  
30A



YNF-042  
30AS



YNF-043  
50A



YNF-044  
50AS



YNF-045  
80A



YNF-046  
80AS



YNF-047  
90A

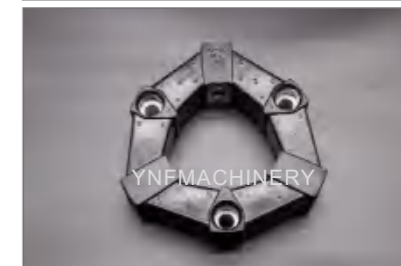

YNF-048  
90AS



YNF02695  
90A (Round type)

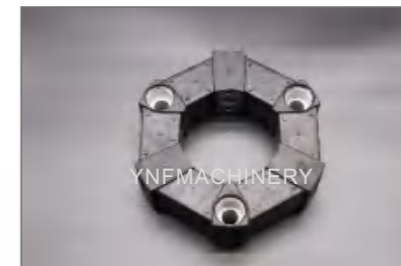

YNF02696  
90AS (Round type)



YNF-049  
140A



YNF-050  
140AS



YNF03461  
140A (Round type)



YNF03462  
140AS (Round type)



## Coupling - A/AS



YNF-051  
200A



YNF-052  
200AS



YNF-053  
250A



YNF-054  
250AS



YNF-055  
400A



YNF-056  
400AS

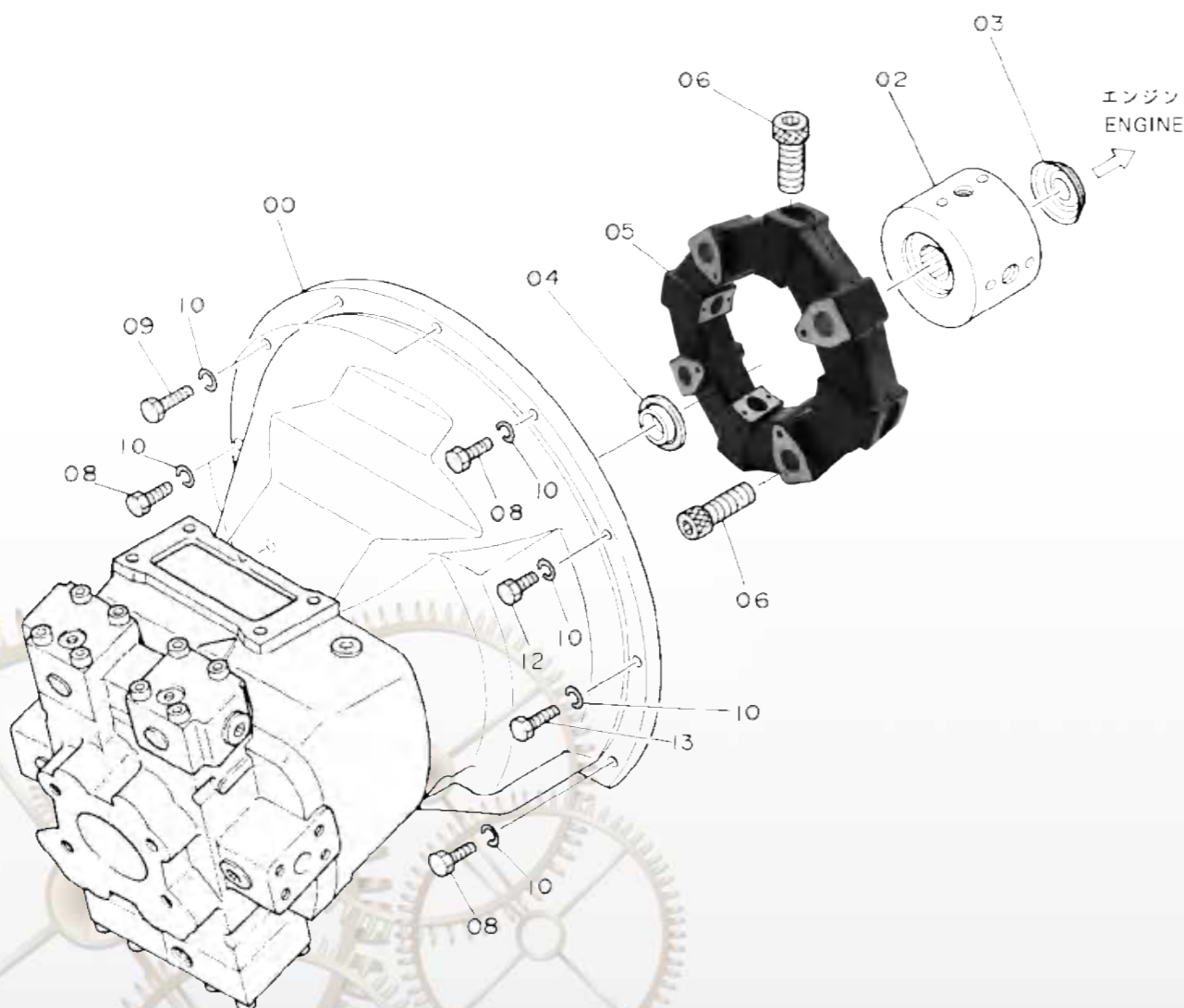

## Coupling - Spline Hub

# Spline Hub



★  YNFMACHINERY	<b>YNF03710</b> ★ OD60-9T OD60 ID12/15.6 H36 Z3 10mm	 YNFMACHINERY	<b>YNF01422</b> ★ OD60-10T OD60 ID14.5/18 H36 Z3 10mm	 YNFMACHINERY	<b>YNF01640</b> OD60-11T OD60 ID19/16.2 H36 Z3 10mm
 YNFMACHINERY	<b>YNF03413</b> ★ OD60-13T OD60 ID19/22 H36 Z3 10mm	 YNFMACHINERY	<b>YNF03718</b> OD60-14T OD60 ID27.3/31.2 H36 Z3 10mm		
★  YNFMACHINERY	<b>YNF03734</b> ★ OD70-10T OD70 ID14.5/18 H43 Z3 12mm	 YNFMACHINERY	<b>YNF02947</b> OD70-11T ID16/19 OD70 H46 Z3 12mm	 YNFMACHINERY	<b>YNF02946</b> OD70-13T OD70 ID19/22 H46 Z4 12mm
 YNFMACHINERY	<b>YNF01880</b> OD70-13T OD70 ID19/22 H50 Z3 12mm	 YNFMACHINERY	<b>YNF01206</b> OD70-15T OD70 ID22-26 H37 Z3 12mm		

## Coupling - Spline Hub

	<b>YNF02930</b> OD85-12T OD85 ID30/35 H45 Z4 16mm		<b>YNF01882</b> OD85-13T OD85 ID19/22 H45 Z3 14mm		<b>YNF00891</b> OD85-14T OD85 ID27/31 H45 Z3
---	--	---	--	--	---

	<b>YNF01641</b> OD85-14T OD85 ID35/40 H53		<b>YNF03761</b> OD85-14T OD85 ID27/31 H43 Z4 16mm		<b>YNF02450</b> OD85-15T OD85 ID22/26 H45 Z3 14mm
---	---	---	--	--	--

	<b>YNF01474</b> OD85-15T OD85 ID36/42 H44 Z4 16mm		<b>YNF03567</b> OD85-16T OD85 ID40/45 H42 Z4 14mm		<b>YNF01213</b> OD85-16T OD85 ID40/45 H42 16mm
--	--	--	--	---	---

	<b>YNF03545</b> OD85-17T OD85 ID28/31 H42 Z3 14mm		<b>YNF02121</b> OD85-17T OD85 ID28/31 H42 Z4		<b>YNF02697</b> OD85-17T OD85 ID42/47 H45 Z4 16mm
---	--	---	---	--	--

★ 	<b>YNF03694</b> ★ OD100 H66 Z4 14mm		<b>YNF04083</b> ★ OD100 ID 55mm		<b>YNF04084</b> OD100 ID 50mm
---	--	---	---------------------------------------	--	-------------------------------------

★ 	<b>YNF02572</b> OD100 ID15mm H66 Z4 14mm		<b>YNF00927</b> OD100-12T OD100 ID30/35 H50 Z4 18mm		<b>YNF01879</b> OD100-12T OD100 ID30/35 H50 Z4 16mm
---	--	---	--	--	--

## Coupling - Spline Hub

	<b>YNF01639</b> OD100-12T OD100 ID30/35 H65 Z4 16mm		<b>YNF01881</b> OD100-13T OD100 ID19/22 H55 Z3 16mm		<b>YNF03851</b> OD100-13T OD100 ID38/46 H62 Z3 16mm
---	--	---	--	---	--

	<b>YNF01198</b> OD100-14T OD100 ID27/31 H57 Z4 16mm		<b>YNF02139</b> OD100-14T OD100 ID28/31.5 H66 Z4 16mm		<b>YNF01477</b> OD100-14T OD100 ID28/33 H66 Z3
---	--	---	--	---	---

	<b>YNF01431</b> OD100-14T OD100 ID35/40 H50 Z4 16mm		<b>YNF02859</b> OD100-14T OD100 ID35/40 H50 Z4 18mm		<b>YNF01642</b> OD100-14T OD100 ID35/40 H62 Z4 18mm
--	--	--	--	--	--

	<b>YNF02325</b> OD100-15T OD100 ID29/34 H57 Z4 16mm		<b>YNF00805</b> OD100-15T OD100 ID29/34 H66 Z3 16mm		<b>YNF01096</b> OD100-15T OD100 ID35/40 H65 Z4 16mm
---	--	---	--	---	--

	<b>YNF01475</b> OD100-15T OD100 ID36/42 H46 Z4 16mm		<b>YNF00854</b> OD100-15T OD100 ID44/51 H45 Z4 16mm		<b>YNF02971</b> OD100-15T OD100 ID44/51 H47 Z4 18mm
---	--	---	--	---	--

	<b>YNF03566</b> OD100-15T OD100 ID44/51 H50 Z4 18mm		<b>YNF02452</b> OD100-16T OD100 ID40/45 H62		<b>YNF01210</b> OD100-17T OD100 ID34/37.8 H54 Z4 16mm
---	--	---	---	---	--

## Coupling - Spline Hub

	<b>YNF02841</b> OD100-17T OD100 ID34/37.8 H54 Z4 16mm		<b>YNF03398</b> OD100-17T OD100 ID40/46 H64+1 Z4 16mm		<b>YNF03894</b> OD100-17T OD100 ID40/46 H64+1 Z4 18mm
	<b>YNF03546</b> OD100-17T OD100 ID42/47 H45 Z4 16mm		<b>YNF03547</b> OD100-17T OD100 ID42/47 H45 Z4 18mm		<b>YNF03548</b> OD100-17T OD100 ID42/47.5 H70 Z4 18mm
	<b>YNF01473</b> OD100-21T OD100 ID40/45 H66 Z3 16mm		<b>YNF03414</b> OD100-21T OD100 ID40/45 H66 Z4 16mm		
	<b>YNF01643</b> OD125-14T OD125 ID35/40 H62 Z4 20mm		<b>YNF01476</b> OD125-15T OD125 ID44/51 H62 Z4 20mm		<b>YNF00846</b> OD125-17T OD125 ID42/47 H62 Z4 20mm
★ 	<b>YNF02453</b> OD125-22T OD125 ID56/60 H62 Z4 20mm		<b>YNF02591</b> OD125-24T OD125 ID46/51 H62 Z4 20mm		
	<b>YNF01479</b> ★ OD160-15T OD160 ID45/52 H60 Z4 20mm		<b>YNF03549</b> ★ OD160-17T OD160 ID42/47 H60 Z4 20mm		<b>YNF03821</b> OD160-21T OD160 ID60/65 H70 Z4 20mm

## Coupling - Flange

# Flange

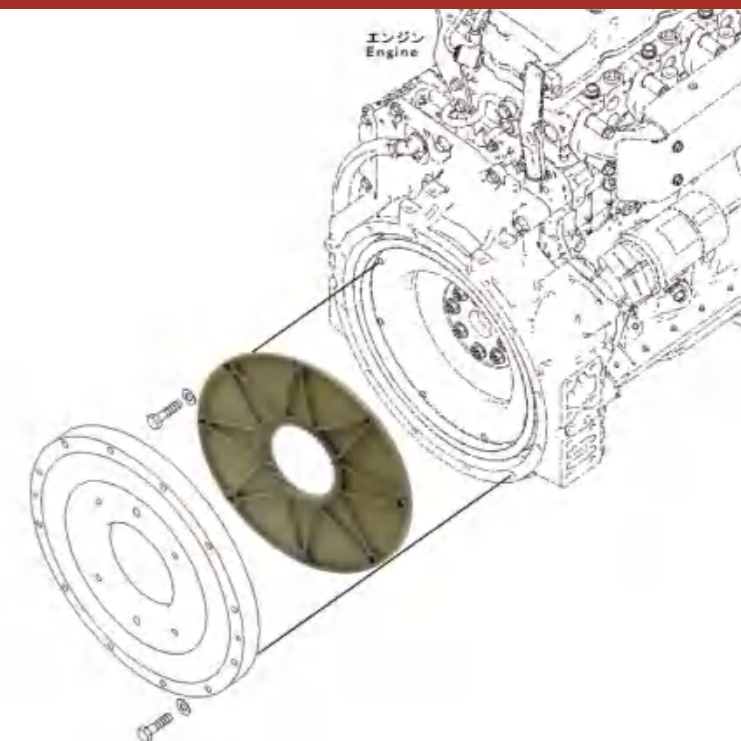

	<b>YNF00946</b> 135x50		<b>YNF-057</b> 150x50		<b>YNF-058</b> 155x50
	<b>YNF02970</b> 165x4		<b>YNF00863</b> 168x26		<b>YNF-059</b> 168x26x13T
	<b>YNF-060</b> 168x47		<b>YNF-061</b> 168x50		<b>YNF-062</b> 178x42

## Coupling - Flange



**YNF-063**  
180x42



**YNF12953**  
188x50



**YNF-064**  
195x6 (black)



**YNF02347**  
200x4



**YNF-065**  
200x50



**YNF01763**  
210x50



**YNF12734**  
215x4



**YNF12936**  
215x47



**YNF-066**  
215x50



**YNF-067**  
220x46



**YNF-068**  
228x46



**YNF02182**  
230x8



**YNF02487**  
240x47



**YNF-069**  
241x50



**YNF12733**  
260x4

## Coupling - Flange



**YNF-070**  
260x46



**YNF02488**  
262x50

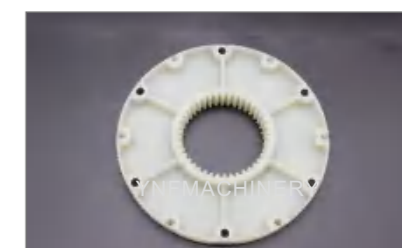

**YNF-071**  
264x42



**YNF-072**  
295x48



**YNF-075**  
314x4



**YNF-164**  
314x6



**YNF04059**  
314x13



**YNF04060**  
314x14



**YNF04061**  
314x15



**YNF03893**  
314x38



**YNF-073**  
314x42 (A type)



**YNF-159**  
314x42 (B type)



**YNF12732**  
314x46



**YNF01600**  
314x47



**YNF-074**  
314x50 (A type)

## Coupling - Flange

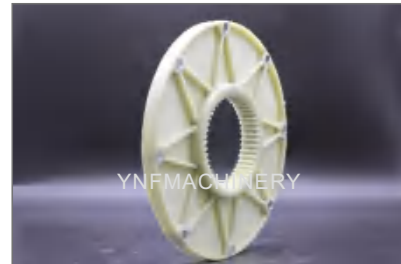

**YNF02489**  
314x50 (B type)

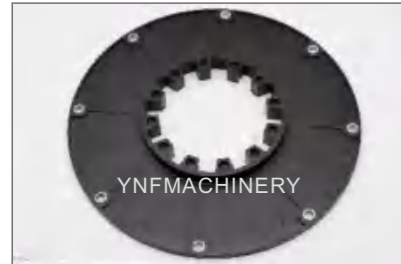

**YNF-081**  
352x8 (A type)



**YNF03813**  
352+165K complete set



**YNF-076**  
352x42



**YNF-079**  
352x54



**YNF04359**  
352x6 (A type)



**YNF02969**  
352x8 (B type)



**YNF-082**  
352x12



**YNF-077**  
352x46

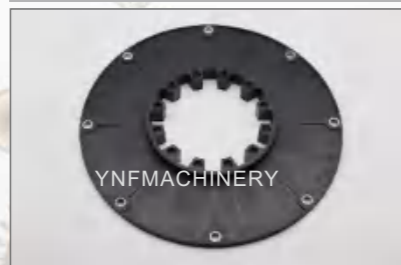

**YNF-163**  
466x12



**YNF04360**  
352x6 (B type)



**YNF04088**  
OD352



**YNF02966**  
352x38



**YNF-078**  
352x48

## Coupling - Gear Hub

# Gear Hub



**YNF04075**

4\*14T  
OD 94  
ID 28/32.5  
H 42



**YNF03501**

4\*14T  
OD 129/97  
ID 27.5/31.5  
H 55



**YNF04235**

4\*15T  
OD 94  
ID 22/26  
H 42



**YNF03536**

6\*14T  
OD 120/85  
ID 28/32  
H 50



**YNF03537**

6\*15T  
OD 120/85  
ID 22/26  
H 50



**YNF03538**

6\*15T  
OD 120/85  
ID 45/51  
H 50



**YNF03540**

6\*17T  
OD 120/85  
ID 27/31  
H 50



**YNF03541**

6\*17T  
OD 120/85  
ID 42/47  
H 50



**YNF03542**



6\*21T  
OD 120/85  
ID 32/35  
H 50





**YNF02801**



6\*23T  
OD 120/85  
ID 35/38  
H 50

## Coupling - Gear Hub

 YNFMACHINERY	<b>YNF04102</b> 8*15T OD 148 ID 44/51 H 70	 YNFMACHINERY	<b>YNF01644</b> 8*17T OD 148/110 ID 42/47 H 57	 YNFMACHINERY	<b>YNF04200</b> 8*24T OD 148 ID 46/51 H 60
---	--	---	--	--	--

 YNFMACHINERY	<b>YNF03553</b> ★ 12*17T OD 210/170 ID 42/47 H 79.6	 YNFMACHINERY	<b>YNF03595</b> ★ 12*18T OD 210/170 ID 42/47 H 79.6	 YNFMACHINERY	<b>YNF03596</b> 12*21T OD 210/170 ID 40/45 H 55
---	---	---	---	--	---

 YNFMACHINERY	<b>YNF03498</b> ★ 12*24T OD 210/170 ID 46/51 H 74	 YNFMACHINERY	<b>YNF03568</b> 26*13T
--	---	---	---------------------------

 YNFMACHINERY	<b>YNF03511</b> ★ 42*6T OD 110 ID 28.5/32.5 H 55	 YNFMACHINERY	<b>YNF12967</b> 42*8/14T OD 110 ID 28/32 H 45	 YNFMACHINERY	<b>YNF01195</b> 42*10/13T OD 110 ID 38/46 H 55
---	--	---	---	--	--

 YNFMACHINERY	<b>YNF03512</b> 42*12T OD 110 ID 30/35 H 55	 YNFMACHINERY	<b>YNF01635</b> 42*13T OD 110 ID 19/22 H 55	 YNFMACHINERY	<b>YNF03400</b> 42*13T OD 110 ID 38/46.5 H 55
---	---	---	---	--	---

 YNFMACHINERY	<b>YNF00502</b> 42*14T OD 110 ID 28/32 H 57	 YNFMACHINERY	<b>YNF03513</b> 42*14T OD 110 ID 35/40 H 56	 YNFMACHINERY	<b>YNF01636</b> 42*15T OD 110 ID 22/25.3 H 55
---	---	---	---	--	---

## Coupling - Gear Hub

 YNFMACHINERY	<b>YNF03514</b> ★ 42*15T OD 110 ID 28.5/33 H 55	 YNFMACHINERY	<b>YNF03427</b> 42*16T OD 110 ID 30/35 H 53	 YNFMACHINERY	<b>YNF02478</b> 42*18T OD 110 ID 36/40 H 70
---	---	---	---	---	---

 YNFMACHINERY	<b>YNF03715</b> ★ 42*21T OD 110 ID 32/35 H 50	 YNFMACHINERY	<b>YNF00523</b> 42*21T OD 110 ID 32/35 H 55	 YNFMACHINERY	<b>YNF00881</b> 42*21T OD 110 ID 40.5/45.5 H 55
---	---	---	---	---	---

 YNFMACHINERY	<b>YNF01633</b> 42*23T OD 110 ID 35.2/38.5 H 70	 YNFMACHINERY	<b>YNF00524</b> ★ 42*23T OD 110 ID 35/38 H 49	 YNFMACHINERY	<b>YNF00843</b> 42T with key OD 110 ID 25/28 H 55
--	---	--	---	--	---

 YNFMACHINERY	<b>YNF01637</b> 46*12T OD 145 ID 30/35 H 56	 YNFMACHINERY	<b>YNF01471</b> 46*12T OD 145 ID 44/51 H 65	 YNFMACHINERY	<b>YNF02643</b> 46*13T OD 145 ID 38/46 H 55
---	---	---	---	---	---

 YNFMACHINERY	<b>YNF01625</b> 46*13T OD 145 ID 38/46 H 70	 YNFMACHINERY	<b>YNF00656</b> 46*14T OD 145 ID 27.2/31.2 H 54	 YNFMACHINERY	<b>YNF01095</b> 46*14T OD 145 ID 35/40 H 53
---	---	---	---	---	---

 YNFMACHINERY	<b>YNF03515</b> 46*14T OD 145 ID 35/40 H 55	 YNFMACHINERY	<b>YNF03516</b> 46*14T OD 145 ID 35/40 H 69	 YNFMACHINERY	<b>YNF01289</b> 46*14T OD 145 ID 40/45 H 54
---	---	---	---	---	---

## Coupling - Gear Hub

	<b>YNF01557</b> 46*14T OD 145 ID 41.6/47.3 H 65		<b>YNF03517</b> 46*15T OD 145 ID 45/52 H 47		<b>YNF03518</b> 46*15T OD 145 ID 45/52 H 54
---	---	---	---	--	---

	<b>YNF02948</b> 46*16T OD 145 ID 30/35 H 54		<b>YNF01472</b> 46*17T OD 145 ID 42/47.5 H 64		<b>YNF03016</b> 46*17T OD 145 ID 42/47.5 H 81
---	---	---	---	--	---

	<b>YNF01627</b> 46*21T OD 145 ID 32/35 H 59		<b>YNF01626</b> 46*21T OD 145 ID 40/45 H 59		<b>YNF02479</b> 46*23T OD 145 ID 35/38 H 60
--	---	--	---	---	---

	<b>YNF01196</b> 46*24T OD 145 ID 46/51 H 57		<b>YNF03519</b> 46*24T OD 145 ID 60/65 H 66		<b>YNF03520</b> 46*27T OD 145 ID 39/43 H 58
---	---	---	---	--	---

	<b>YNF01278</b> 47*13T OD 98 ID 19/22 H 55		<b>YNF03521</b> 47*13T OD 98 ID 38/46.5 H 60		<b>YNF03430</b> 47*14T OD 98 ID 28/32 H 40
---	--	---	--	--	--



	<b>YNF03522</b> 47*14T OD 98 ID 28/32 H 40		<b>YNF02679</b> 47*15T OD 98 ID 22/26 H 46
---	--	---	--



## Coupling - Gear Hub



	<b>YNF01398</b> 48*13T OD 176 ID 38/46 H 65		<b>YNF01634</b> 48*13T OD 176 ID 38/46 H 74		<b>YNF03554</b> 48*13T OD 176 ID 38/46 H 74
---	---	---	---	---	---

	<b>YNF01421</b> 48*14T OD 176 ID 35/40 H 66		<b>YNF02600</b> 48*15T OD 176 ID 45/52 H 58		<b>YNF03524</b> 48*17T OD 176 ID 42/47 H 58
---	---	---	---	---	---

	<b>YNF01205</b> 48*17T OD 176 ID 42/47 H 63		<b>YNF03523</b> 48*21T OD 176 ID 40.5/45.5 H 57		<b>YNF01566</b> 48*24T OD 176 ID 45.5/50.5 H 64
--	---	--	---	--	---

	<b>YNF03525</b> 48*24T OD 176 ID 45.5/50.5 H 110		<b>YNF03526</b> 48*27T OD 176 ID 45/48 H 65		<b>YNF02571</b> 48*28T OD 176 ID 56.5/61 H 70
---	--	---	---	---	---

	<b>YNF03527</b> 50*6T OD 78 ID 19.7/23.9 H 42.9		<b>YNF02682</b> 50*10T OD 78 ID 19/22.8 H 36.5		<b>YNF01084</b> 50*11T OD 78 ID 16/19 H 42
---	---	---	--	---	--

	<b>YNF00864</b> 50*13T OD 78 ID 19/22 H 44		<b>YNF03472</b> 50*13T OD 78 ID 20/22.5 H 43		<b>YNF00947</b> 50*14T OD 78 ID 28/32 H 44
---	--	---	--	---	--

## Coupling - Gear Hub

	<b>YNF01638</b> 50*15T OD 78 ID 22/26 H 44		<b>YNF02840</b> 50*15T OD 78 ID 29/33.2 H 44		
	<b>YNF02837</b> 50*12T OD 130 ID 30/35 H 54		<b>YNF03415</b> 50*13T OD 130 ID 38/46 H 55		<b>YNF00618</b> 50*14T OD 130 ID 28/32 H 55
	<b>YNF00619</b> 50*14T OD 130 ID 28/32 H 68		<b>YNF02833</b> 50*14T OD 130 ID 35/40 H 54		<b>YNF03141</b> 50*14T OD 130 ID 35/40 H 68
	<b>YNF03528</b> 50*15T OD 130 ID 29/34 H 54		<b>YNF03529</b> 50*17T OD 130 ID 42/47 H 67		<b>YNF03530</b> 50*21T OD 130 ID 40.5/45.5 H 54
	<b>YNF03531</b> 50*23T OD 130 ID 35/38 H 54		<b>YNF03532</b> 50*24T OD 130 ID 46/51 H 53		
	<b>YNF01427</b> 54*15T OD 225 ID 44/51 H 71.5		<b>YNF03552</b> ★ 54*17T OD 225 ID 42/47.5 H 72.8		<b>YNF02490</b> 54*18T OD 225 ID 36/40 H 71

## Coupling - KY

	<b>YNF03872</b> 180x50T		<b>YNF03952</b> 198x50T		<b>YNF-104</b> 215x50T
	<b>YNF01057</b> 241x42T		<b>YNF01778</b> 241x50T (Iron Bottom)		<b>YNF-161</b> 314x46T
	<b>YNF-160</b> 314x46T (Iron Bottom)		<b>YNF00888</b> 314x50T (Iron Bottom)		<b>YNF-105</b> 314KY (With Hub)
	<b>YNF05150</b> 352KY (with hub)		<b>YNF-162</b> 352x46T (Iron Bottom)		<b>YNF-106</b> 352x46T
	<b>YNF04437</b> 466KY		<b>YNF01779</b> 466x48T (Iron Bottom)		<b>YNF03797</b> 466x54T
	<b>YNF04354</b> LKB1000				



**Coupling - GC**

**GC  
COUPLINGS**



**YNF-097**  
270×24T



**YNF03820**  
301×24T



**YNF-099**  
310X24T ID56



**YNF02474**  
335×24T (16z)



**YNF-095**  
245×12T



**YNF03379**  
275×24T



**YNF03886**  
CM1200



**YNF01755**  
335×24T (8z)



**YNF01754**  
335×24T (24z)



**YNF-096**  
262x24T



**YNF-098**  
295×24T



**YNF02473**  
305×24T



**YNF-100**  
335×24Tx12T



**YNF01776**  
388×24T



**YNF01756**  
390×24T



**YNF03387-1**  
402x24T (With Hub)



**YNF03850**  
430x24T (12z)



**YNF12244**  
435x28T HCT400A



**YNF-103**  
450×24T



**YNF-101**  
400×24T



**YNF02593**  
406×24T



**YNF03745**  
435x24T (8z)



**YNF-102**  
440×24T



**YNF-103H**  
450×24T (thick type)



**YNF03387**  
402x24T (Without Hub)



**YNF02965**  
428×24T



**YNF01777**  
435×24T (8z+8z)



**YNF03880**  
442×24T



**YNF12639**  
310x24T ID59.5

**Coupling - GC**

### Coupling - CB/S

			
YNF04043 CB116-11T	YNF-115 CB116-13T	YNF-116 CB116-14T	YNF-117 CB146-13T
			
YNF03844 CB146-14T	YNF-118 CB146-15T	YNF-119 CB146-17T	
			
YNF-120 CB160-13T	YNF-121 CB160-15T	YNF02596 CB160-14T	
			
YNF03203 S22S OD132	YNF-092 S25S OD143	YNF-093 S29S OD150	
			
YNF-094 S32S OD239	YNF01619 SAGA034	YNF01757 GA028	

### Coupling - TFC/Rubber Block

		
YNF-086 15T SH160	YNF-083 12T	YNF-084 14T SH200 50ACM
		
YNF-085 14T E200B 50AC	YNF-087 15T E320B	YNF-088 16T 50AM
		
YNF-089 16T E300B	YNF-090 16T E450	YNF-091 20T SH280 50ASM

### Rubber Block

		
YNF02815 OD75XH55	YNF03469 OD90XH70	YNF03470 OD75XH70

### Coupling - Damper/YC



**YNF-122**  
PC60-7 PC75UU 4D102  
[210×22×19]



**YNF-123**  
PC60-7 4D95  
[180×22×19]



**YNF-124**  
PC100 PC60-5 PC50-6  
[180×18×16]



**YNF-125**  
PC120-5 PC60-5  
PC60-6 change pump  
[180×18×14]



**YNF-126**  
PC120-6 4D102  
[220×17×16]



**YNF-127**  
PC120-6 4D95  
[168×17×16]



**YNF-128**  
PC130-7  
[168×18×18]



**YNF03858**  
YC18 (without hub)

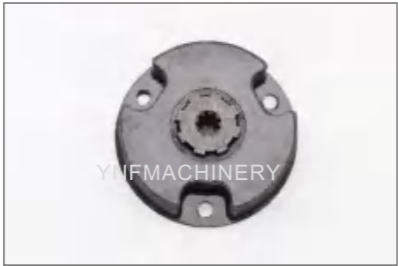

**YNF-107**  
YC18 9T



**YNF01764**  
YC18 13T

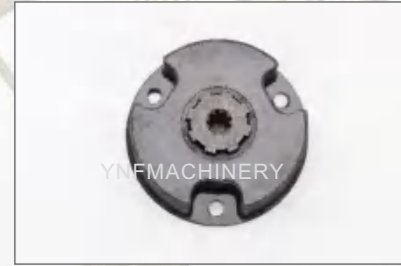

**YNF12766**  
YC18 14T



**YNF02574**  
YC18 15T



**YNF03853**  
YC35 (without hub)

### Coupling - YC



**YNF-108**  
YC35-9T



**YNF-109**  
YC35-13T



**YNF-110**  
YC35-14T



**YNF01765**  
YC60-7 175-9T



**YNF01766**  
YC60-7 175-13T

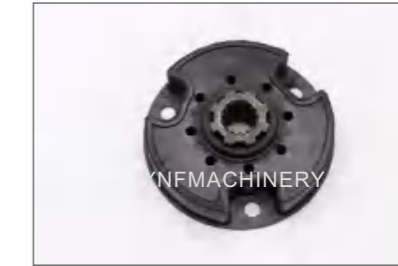

**YNF01767**  
YC60-7 175-14T



**YNF-112**  
YC60-7 175-15T



**YNF01768**  
YC60-8 240-9T



**YNF01769**  
YC60-8 240-13T



**YNF01770**  
YC60-8 240-14T



**YNF-113**  
YC60-8 240-15T



**YNF-114**  
FR60 180-15T



**YNF03837**  
E304 E305.5 13T



**YNF12595**  
E304 14T



**YNF03836**  
E304 15T

## Coupling - Cluth



YNF02828  
D65-15 22T

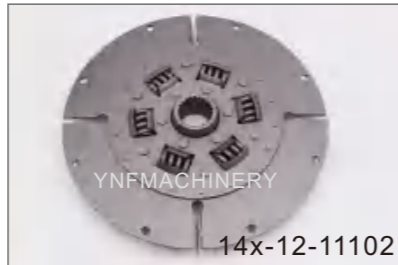

YNF0129  
D6-12 D65 22T



YNF0133  
PC200-3 16T



YNF0134  
PC200-5 PC200-6 16T



YNF0135  
PC200-7 PC200-8 16T



YNF0136  
PC300-6/400-6/400-7 22T



YNF0137  
PC300-7 20T



YNF01758  
14T K3V63 OD344×14T



YNF01759  
PC180-6 24T



YNF01760  
E345 15T



YNF05215  
E345 17T



YNF0130  
R445 R450



YNF0138  
Liebherr R934 R944 24T



YNF05216  
DH400-7

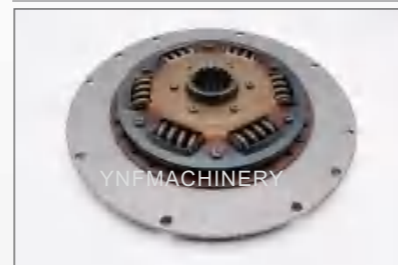

YNF05217  
EC360 EC460 17T

## Coupling - GR Spider Coupling



YNF01761  
without gear hub



YNF11251  
D31 D37



YNF11247  
D41 D53

## Spider Coupling



YNF03484  
GR28



YNF03485  
GR42



YNF03486  
GR48



YNF03487  
GR55



YNF03488  
GR65



YNF03489  
GR75



YNF03490  
GR90



YNF03491  
GR100



YNF03492  
GR110

## Coupling - Hose Coupling

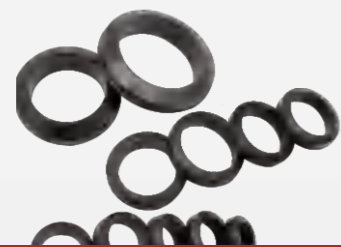

### Hose Coupling Seal

Purchase No.	Size
YNF0139	φ25
YNF0140	φ32
YNF02544	φ34
YNF0141	φ38
YNF0142	φ42
YNF12500	φ45
YNF0143	φ48
YNF0144	φ51
YNF0145	φ56
YNF0146	φ60
YNF0147	φ76
YNF0148	φ90



### Hose Coupling Assembly

Purchase No.	Size
YNF0149	φ25
YNF0150	φ32
YNF02545	φ34
YNF0151	φ38
YNF0152	φ42
YNF12501	φ45
YNF0153	φ48
YNF0154	φ51
YNF0155	φ56
YNF0156	φ60
YNF0184	φ76

## Coupling - J series

### J SERIES COUPLINGS



YNF12742

3J



YNF12743

4J



YNF12744

5J



YNF12745

6J



YNF12746

7J



YNF12747

8J



YNF12748

9J



YNF03859

10J



YNF12749

11J



YNF12750

12J



YNF12751

13J



YNF12908

14J